



15 Stable Walk, Hull, HU3 6AD
£145,000

The Property Perspective

Garden Place, Victoria Street, Altrincham, WA14 1ET

Tel: 08456 800 262 Fax: 08456 800 272

Email: enquiries@thepropertyperspective.co.uk www.thepropertyperspective.co.uk

PROPERTY
PERSPECTIVE

We are delighted to offer for sale this modern end terraced house with open aspect to the front located on a popular development with access to amenities and transport links.

As you would expect the property benefits from gas central heating and PVCu double glazing. There is a modern breakfast kitchen with integrated appliances plus contemporary bathroom and WC. Items of note include French doors to the rear and fitted wardrobes to bedroom 1. There are ample sockets and media points to the property. The home is ready to move in with flooring and blinds included as fitted.

To the ground floor is an entrance hall, lounge, breakfast kitchen and WC. There are 2 double bedrooms plus a family bathroom accessed from the first floor landing.

The property benefits from well presented gardens with lawn and patio. There is a designated parking space.

Tenure - Freehold
Estate Management Fee - £85 pa.
Council Tax - Band B

The property comprises.

GROUND FLOOR

Entrance Hall

With laminate flooring.

Lounge 14'6"(max) x 10'5"(max) (4.42m(max) x 3.20m(max))

With laminate flooring and curtains. Access to store plus French doors leading to rear garden.

Breakfast Kitchen 11'7" x 7'4" (3.55m x 2.26m)

Having a comprehensive range of modern wall and base units with complimenting laminate worktops, tiling and stainless steel splash back plus breakfast bar. With integrated oven, hob, hood, dishwasher, fridge freezer and washing machine. With tiled flooring and blind.

WC 4'8" x 3'2" (1.43m x 0.97m)

Having contemporary white sanitary ware plus tiling and floor tiling.

FIRST FLOOR

Landing

With fitted carpets.

Bedroom 1 14'6" x 8'10" (4.43m x 2.71m)

With fitted wardrobes, laminate flooring and blind.

Bedroom 2 14'7"(max) x 7'7"(max) (4.45m(max) x 2.32m(max))

With carpets and blinds plus access to store.

Bathroom 7'4"(max) x 5'4"(max) (2.26m(max) x 1.63m(max))

Having contemporary white sanitary ware with shower and screen to bath, tiling and floor tiling.

EXTERNAL

The property benefits from well presented gardens with lawn and patio. There is a designated parking space.

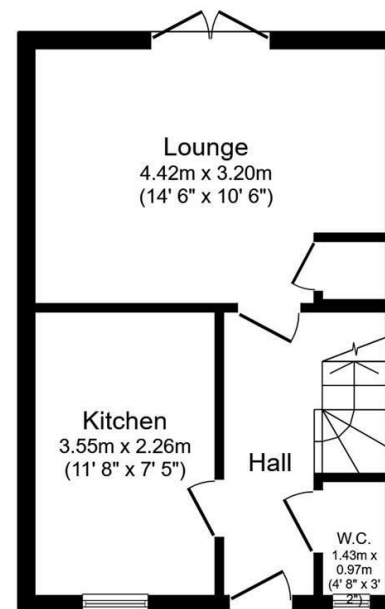

Ground Floor

Floor area 30.2 sq.m. (325 sq.ft.)

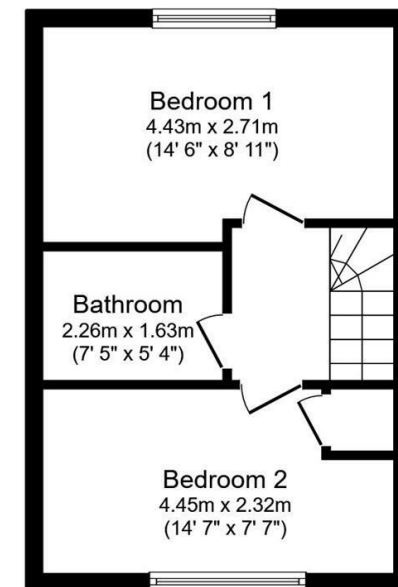

First Floor

Floor area 30.2 sq.m. (325 sq.ft.)

Total floor area: 60.3 sq.m. (649 sq.ft.)

This floor plan is for illustrative purposes only. It is not drawn to scale. Any measurements, floor areas (including any total floor area), openings and orientations are approximate. No details are guaranteed, they cannot be relied upon for any purpose and do not form any part of any agreement. No liability is taken for any error, omission or misstatement. A party must rely upon its own inspection(s). Powered by www.PropertyBox.io

PROPERTY
PERSPECTIVE